

Imperial sizes

Code 0411: 90° HSS M35 (5%) Cob

Code 0414: 82° HSS M35 (5%) Cob

Code 0412: 60° HSS M35 (5%) Cob

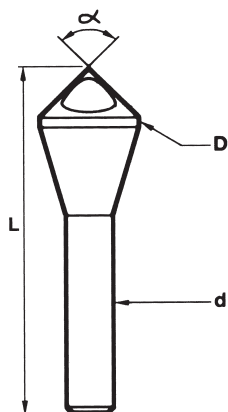

No.	D"	d"	L	90° 82° Price £	60° Price £
0	1/4	1/4	45	10.15	16.80
1	7/16	1/4	45	8.30	12.70
2	9/16	1/4	50	11.20	16.65
3	13/16	1/2	66	20.30	32.50
4	1 3/16	1/2	90	42.65	68.95

* Double end

Reamers

Centre Drills &
Spotting Drills

Metric sizes

Code 0411: 90° HSS M35 (5%) Cob

Code 4811: 90° HSS M35 (5%) Cob TiN coated

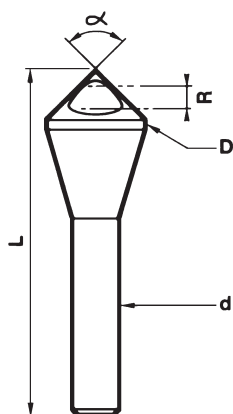

D	R	d	L	M35 Price £	TiN Price £
5	2 - 5	6	45	7.90	13.85
10	4 - 9	6	45	9.10	13.85
15	6 - 14	6 - 8	48 - 55	10.80	18.60
20	8 - 18	10	65	21.85	30.45
25	10 - 23	12	78	26.20	45.60
28	11 - 26	12	86	33.50	57.90
30	12 - 28	12	88	35.30	63.25
35	14 - 33	15	116	49.95	73.85
40	16 - 38	16	136	82.45	93.95
50	20 - 48	16	136	113.15	132.45

D	R	MTS	L	M35 Price £	TiN Price £
63	26-60	3	182	160.55	-
80	32-77	4	229	297.45	-

Countersinks
Counterbores

Slot Drills
End Mills

Taps
Dies

TUSA
Carbide Tooling

COUNTERSINKS

3 Flute

90°

Code 0431: HSS M35 (5%) Cob

Code 0436: HSS M42 (8%) Cob

Code 4831: HSS M35 (5%) Cob TiN coated

Code 4936: HSS M42 (8%) Cob Futura coated

D	R	Screw Ø	d	L	M35	M42	M35 TiN	M42 TiCN
					Price £	Price £	Price £	Price £
4.3	1.3-4.3	M2	4	40	7.85	-	-	-
5	1.5-5.0		4	40	7.85	-	-	-
5.3	1.5-5.3	M2.5	4	40	7.85	-	-	-
5.8	1.5-5.8		5	45	10.55	-	-	-
6	1.5-6.0		5	45	7.85	-	-	-
6.3	1.5-6.3	M3	5	45	7.85	16.20	13.00	19.90
7	1.8-7.0		6	50	9.00	-	-	-
7.3	1.8-7.3	M3.5	6	50	9.00	-	-	-
8	2.0-8.0		6	50	9.00	-	-	-
8.3	2.0-8.3	M4	6	50	9.00	18.65	15.50	24.10
9	2.2-9.0		6	50	9.00	-	-	-
9.4	2.2-9.4	M4.5	6	50	9.00	-	-	-
10	2.5-10.0		6	50	9.00	-	-	-
10.4	2.5-10.4	M5	6	50	9.00	21.85	17.45	27.20
11.5	2.5-11.5		8	56	10.80	-	-	-
12	2.8-12.0		8	56	10.80	-	-	-
12.4	2.8-12.4	M6	8	56	10.80	25.35	20.15	31.30
13.4	2.8-13.4		8	56	19.80	-	-	-
14.4	2.9-14.4		8	56	10.80	-	-	-
15	3.2-15.0		10	60	10.80	-	-	-
16.5	3.2-16.5	M8	8	55	10.80	32.70	24.95	39.25
19	3.5-19.0		10	60	17.05	-	-	-
20.5	3.5-20.5	M10	10	63	17.05	41.95	31.30	50.10
23	3.8-23.0		10	63	26.95	-	-	-
25	3.8-25.0	M12	10	67	26.15	48.50	40.10	57.50
26	3.8-26.0		10	67	34.60	-	-	-
28	3.8-28.0		12	67	32.40	-	-	-
30	4.0-30.0		12	71	41.25	-	-	-
31	4.2-31.0		12	71	37.15	81.65	57.90	93.10
Tri Flat Shank								
35	7.0-35.0		16	103	49.90	-	94.75	-
40	8.0-40.0		16	118	87.60	-	120.95	-
50	10.0-50.0		16	126	120.85	-	166.00	-
63	10.0-63.0		16	140	168.55	-	232.35	-
80	14.0-80.0		16	166	315.90	-	418.25	-

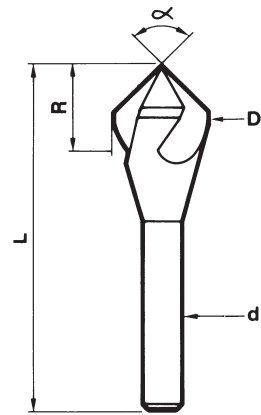

for Quality & Service

www.toolex.co.uk

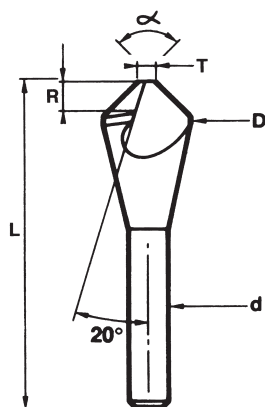
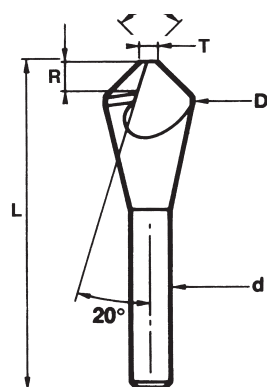

30°

Code 0426: HSS M35 (5%) Cob

D	R	d	L	T	Price £
10	6-10	6	49	5.50	30.45
15	9-15	8	61	8.50	42.75
20	12-20	10	72	11.00	77.15
25	14-25	12	87	13.50	120.15
30	17-30	12	94	16.50	169.30

45°

Code 0427: HSS M35 (5%) Cob

D	R	d	L	T	Price £
6	3 - 6	6	43	2.0	26.80
10	4 - 10	6	49	3.0	30.45
15	5 - 15	8	61	4.5	42.75
20	7 - 20	10	72	6.0	77.15
25	8 - 25	12	87	7.5	120.15
30	10 - 30	12	94	9.0	169.30

60°

Code 0422: HSS M35 (5%) Cob

D	R	d	L	Price £
6	1 - 6	6	43	10.50
10	1 - 10	6	49	12.45
12	2 - 12	8	53	14.35
15	2 - 15	8	60	16.80
20	2 - 20	10	72	29.05
25	3 - 25	12	87	46.45
30	3 - 30	12	98	65.25

82°

Code 0424: HSS M35 (5%) Cob

D	R	d	L	Price £
6	1 - 6	6	41	10.50
10	1 - 10	6	46	12.45
12	2 - 12	8	50	14.35
15	2 - 15	8	56	16.80
20	2 - 20	10	65	29.05
25	3 - 25	12	78	46.45
30	3 - 30	12	88	65.25

Reamers

Centre Drills & Spotting Drills

Countersinks
Counterbores

Slot Drills
End Mills

Taps
Dies

TUSA
Carbide Tooling

COUNTERSINKS

Single Flute

COUNTERBORES

90°

Code 0421: HSS M35 (5%) Cob

D	R	d	L	Price £
4	1 - 4	4	40	6.45
5	1 - 5	5	40	6.80
6	1 - 6	6	40	7.15
8	1 - 8	6	40	7.85
10	1 - 10	6	45	8.60
12	2 - 12	8	50	10.05
15	2 - 15	8	55	10.80
20	2 - 20	10	65	18.90
25	3 - 25	12	78	26.20
30	3 - 30	12	88	35.30
35	4 - 35	16*	110	58.15
40	5 - 40	16*	115	71.00
50	12 - 50	16*	120	97.85

*Tri Flat Shank



for Quality & Service

www.toolex.co.uk

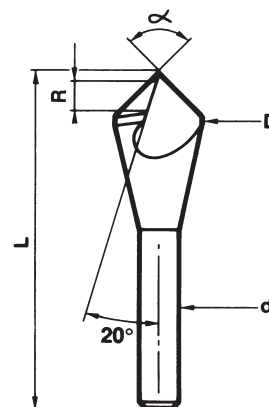

100°

Code 0425: HSS M35 (5%) Cob

D	R	d	L	Price £
10	1 - 10	6	44	14.35
12	2 - 12	8	48	18.20
15	2 - 15	8	54	20.40
20	2 - 20	10	63	36.40
25	3 - 25	12	76	55.85
30	3 - 30	12	85	80.00

120°

Code 0423: HSS M35 (5%) Cob

D	R	d	L	Price £
10	1 - 10	6	43	14.35
12	2 - 12	8	46	18.20
15	2 - 15	8	52	20.40
20	2 - 20	10	61	36.40
25	3 - 25	12	73	55.85
30	3 - 30	12	82	80.00

Code 8431: Also available in Hard X

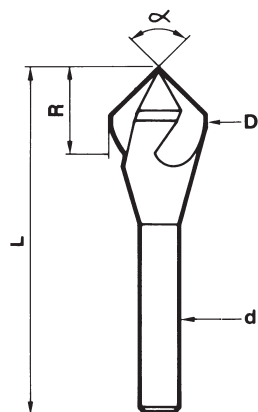

D		d*	L	Price £
4.3	1.3 - 4.3	4	40	41.10
5.3	1.5 - 5.3	4	40	44.40
6.3	1.5 - 6.3	5	45	47.65
8.3	2.5 - 8.3	6	50	55.45
10.4	2.5 - 10.4	6	50	61.20
12.4	3 - 12.4	8*	56	66.10
16.5	4 - 16.5	10*	60	74.30
20.5	4 - 20.5	10*	63	107.85
25	5 - 25.0	10*	67	141.45
31	6 - 31.0	12*	71	189.75

* Tri flat

Reamers

Centre Drills &
Spotting Drills

Countersinks
Counterbores

Slot Drills
End Mills

Taps
Dies

TUSA
Carbide Tooling

Piloted Countersinks DIN 1866

90°

Code 0032: HSS M35 (5%) Cob

Size	D x d	L	d2	Price £
M1.0	2.0 x 1.1	45	D	16.70
M1.2	2.5 x 1.3	45	D	16.70
M1.4	2.8 x 1.5	45	D	13.85
M1.6	3.3 x 1.7	56	D	13.85
M1.8	3.8 x 1.9	56	D	15.15
M2.0	4.3 x 2.2	56	D	15.15
M2.5	5.0 x 2.7	56	D	15.15
M3.0	6.0 x 3.2	71	D	17.45
M3.5	7.0 x 3.7	71	D	18.00
M4.0	8.0 x 4.3	71	D	18.90
M5.0	10.0 x 5.3	80	D	21.45
M6.0	11.5 x 6.4	80	D	25.75
M8.0	15.0 x 8.4	100	12.5	35.20
M10.0	19.0 x 10.5	100	12.5	51.35

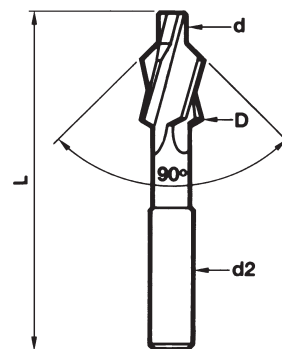

Piloted Counterbores DIN 373

180°

Code 0031: HSS M35 (5%) Cob

Size	D x d	L	d2	Price £
M1.0	2.2 x 1.1	45	D	14.90
M1.2	2.5 x 1.3	45	D	14.90
M1.4	2.8 x 1.5	45	D	13.90
M1.6	3.3 x 1.7	56	D	13.90
M1.7	3.8 x 1.8	56	D	13.90
M2.0	4.3 x 2.2	56	D	13.90
M2.3	4.6 x 2.4	56	D	14.85
M2.6	5.5 x 2.8	71	D	14.85
M3.0	6.0 x 3.2	71	D	15.15
M3.5	6.5 x 3.7	71	D	15.15
M4.0	8.0 x 4.3	71	D	15.30
M5.0	10.0 x 5.3	80	D	17.45
M6.0	11.0 x 6.4	80	D	19.10
M8.0	15.0 x 8.4	100	12.5	26.60
M10.0	18.0 x 10.5	100	12.5	34.55
M12.0	20.0 x 13.0	100	12.5	47.25

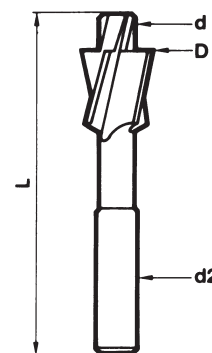

for Quality & Service

www.toolex.co.uk